

TOWNSHIP N^o 14 NORTH RANGE N^o 2 WEST

GILA AND SALT RIVER MERIDIAN.

3001

OFFICIALLY FILED 11-7-1871

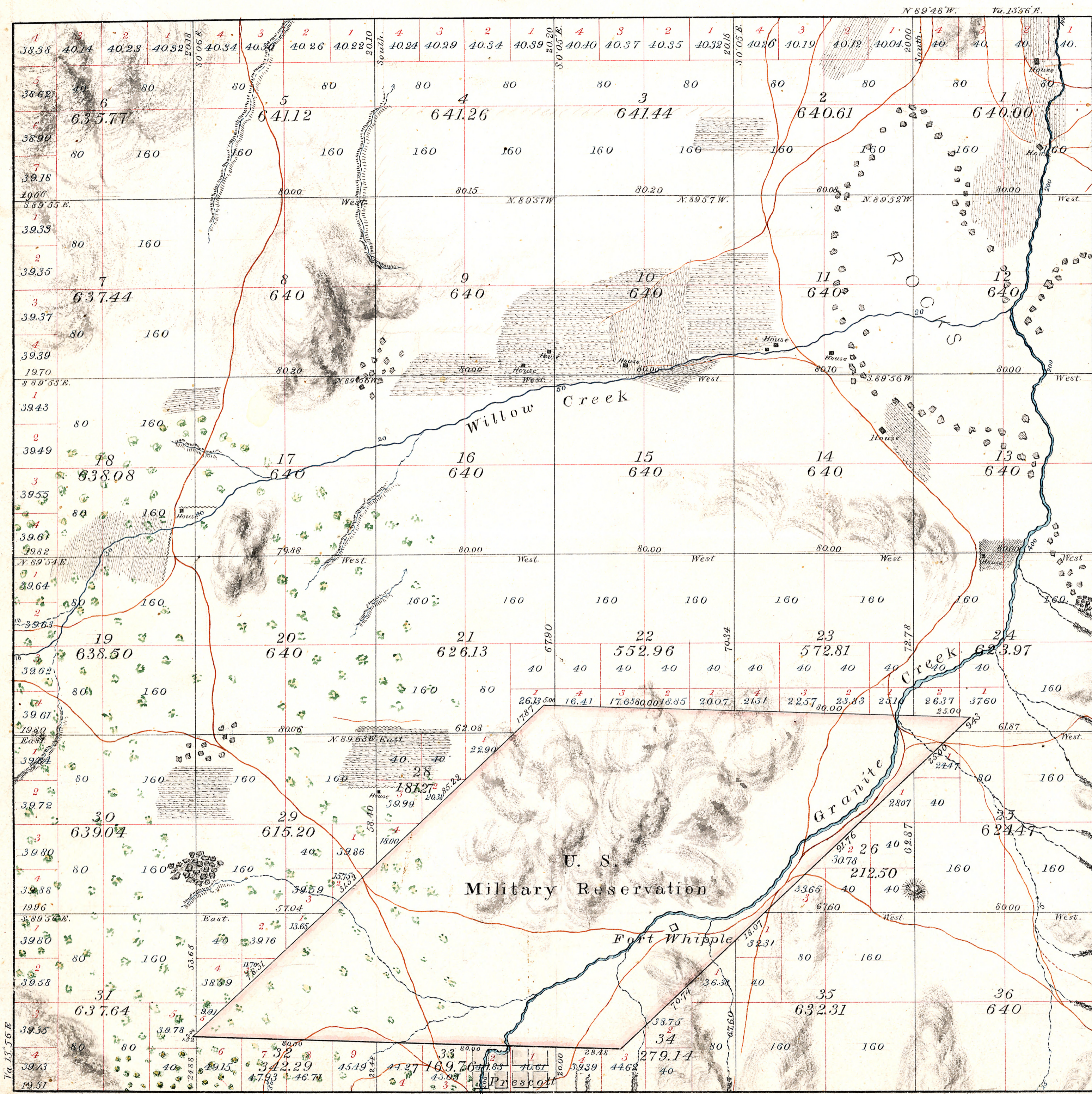

Am't. of Publiclands surveyed	20,143.71 acres
" " land in Reservation	2,888.00 "
Total.	23,031.71 "

Subdivision lines run at a Variation of 13' 45" East.

Surveys Designated	By Whom Surveyed	Date of Contract	Amount of Surveys	When Surveyed
Township lines	J. W. Foreman	May 29, 1871	23 ms. 78 cts 61 ¹ / ₂	Aug. 2-9, 1871.
Subdivisions.	do.	do.	50 " 49 " 69 "	Aug. 16-23, 1871.

The above Map of Township No. 14 North of Range No. 2 West of the Gila and Salt River Meridian, is strictly conformable to the field notes of the survey thereof, on file in this Office, which have been examined and approved.

Surveyor General's Office
Tucson Arizona October 20, 1871

J. W. Foreman
Supt. Genl.