

TOWNSHIP N^o 14 NORTH RANGE N^o 3 WEST
GILA AND SALT RIVER MERIDIAN

OFFICIALLY FILED

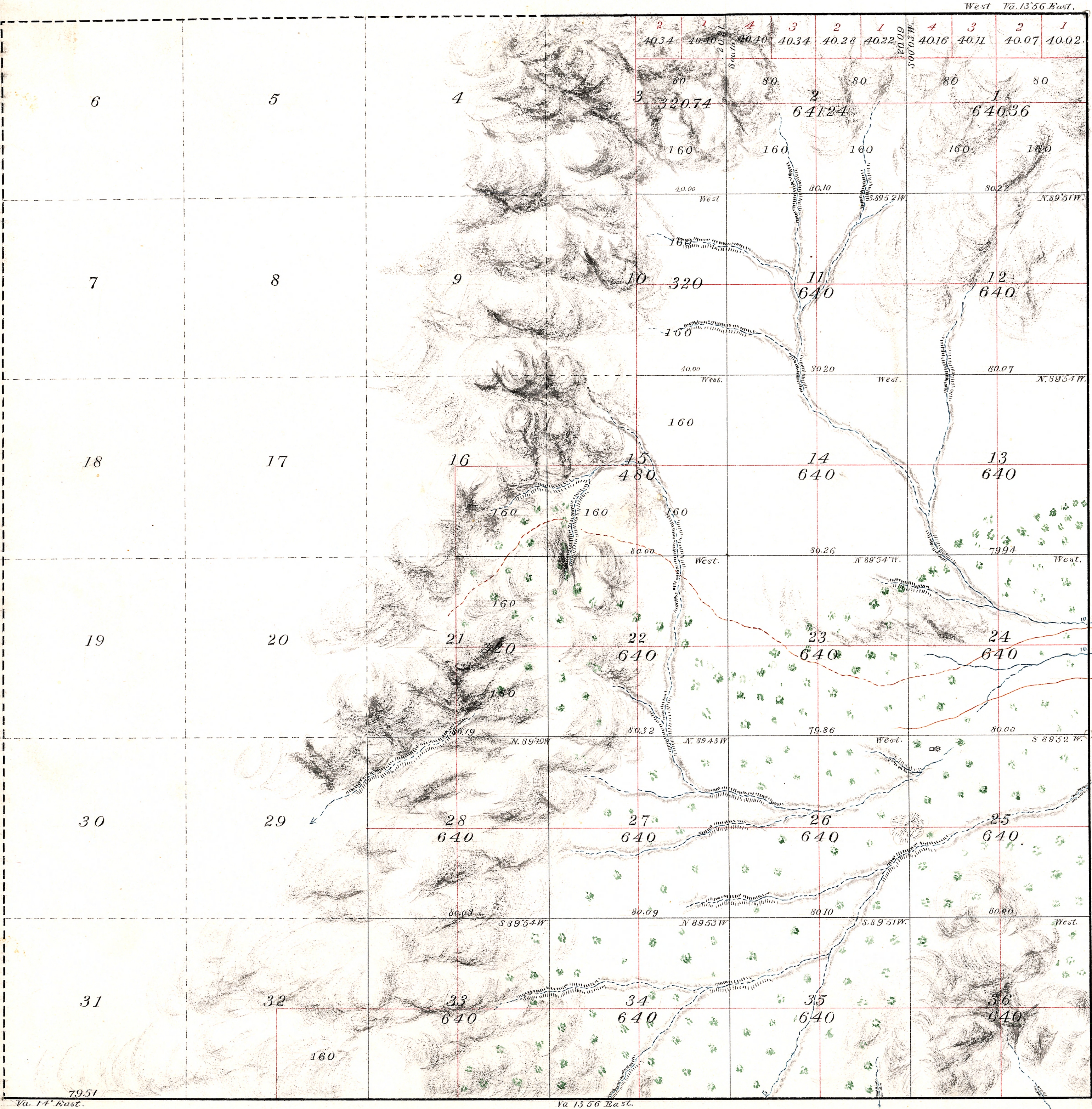

Amt of Public lands surveyed.	12,642.31 acres
" " lands unsurveyed (m ^{ts})	10,380.00 "
<i>Total</i>	<i>23,022.31</i>

Subdivision lines run at a Variation of 13.56 East.

Surveys Designated	By Whom Surveyed	Date of Contract	Amt. of Surveys	When Surveyed
Township lines	A. H. Foreman	May 29, 1871	14 tms. 79 cts. 57 lvs.	Aug. 1-10, 1871
Subdivisions.	do.	do	34 " 1 " 73 "	Aug. 24-29, 1871

The above Map of Township N^o 14 North of Range 3 West of the Gila and Salt River Meridian, is strictly conformable to the field notes of the survey thereof on file in this Office, which have been examined and approved.

Surveyor General's Office
Tucson, Arizona October 20, 1871

John H. Basson
Sur. Genl.